

689 (DUAL SPEED)

629 (SINGLE SPEED)

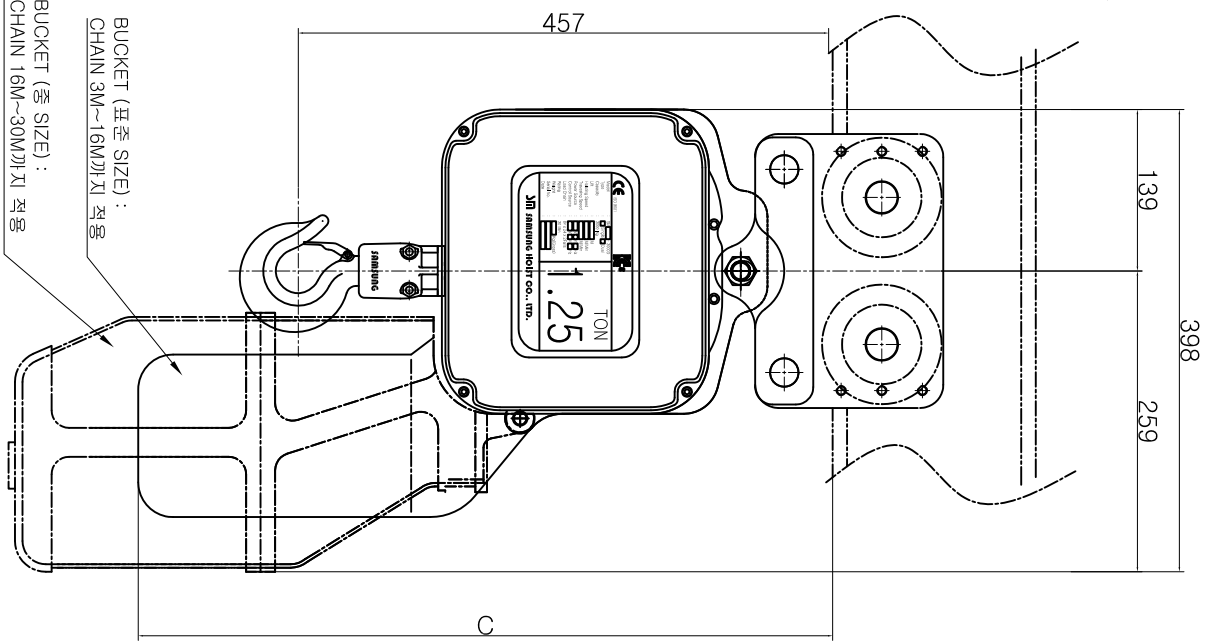
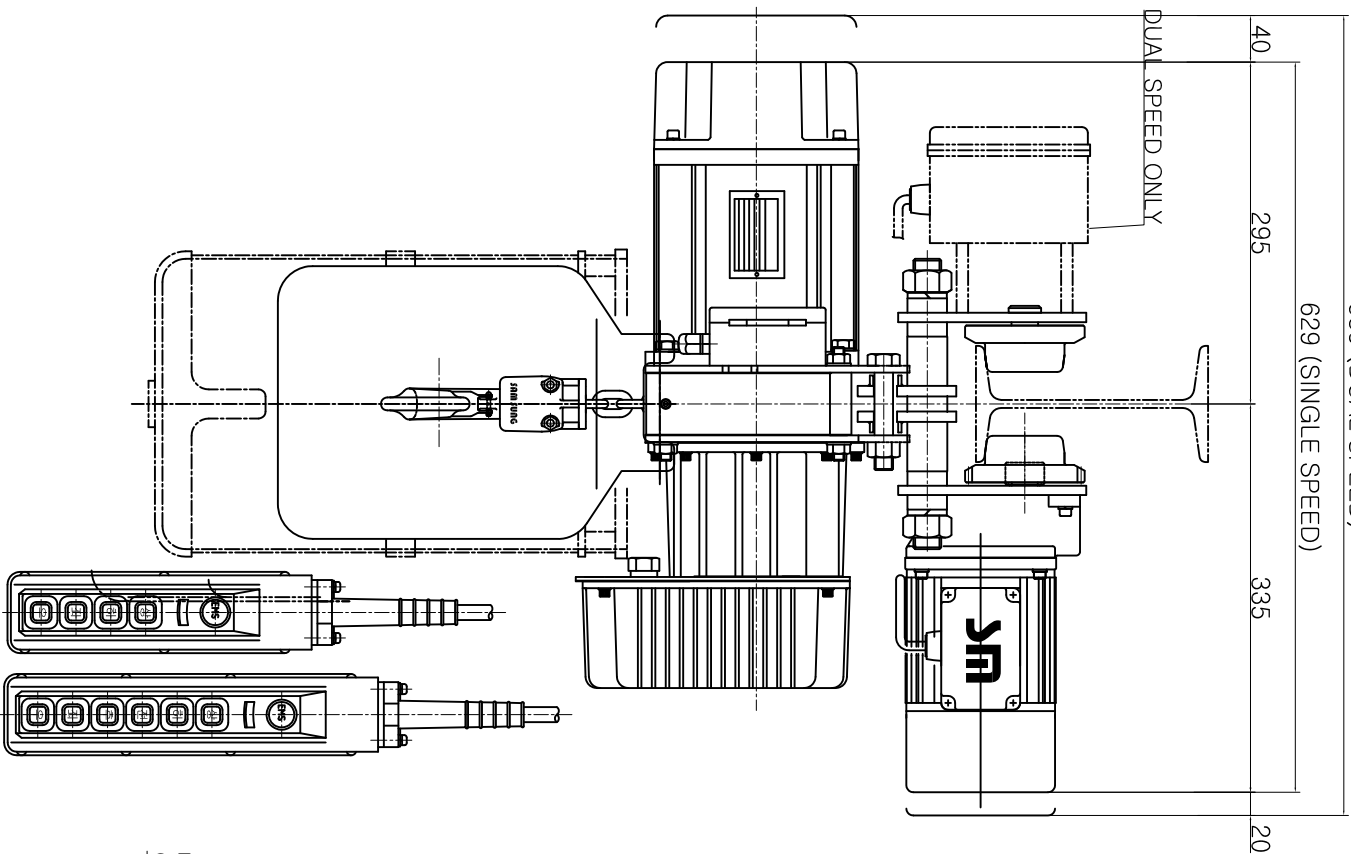

BUCKET (표준 SIZE) :
CHAIN 3M~16M까지 적용
BUCKET (중 SIZE) :
CHAIN 16M~30M까지 적용

SPECIFICATION

HOISTING LOAD	1.25 TON	
TESTING LOAD	1.56 TON	
LIFTING HEIGHT	Min. 30 M ~ Max 90 M	
HOISTING	SINGLE SPEED	7.0 M/MIN
	MOTOR	2.0 Kw x 4 P
DUAL	SPEED	7.0/3.5 M/MIN
	MOTOR	2.0 / 1.0 Kw x 4 / 8 P
FAST	SPEED	20.0 M/MIN
	MOTOR	0.4 Kw x 4 P
MIDDLE	SPEED	13.3 M/MIN
	MOTOR	0.27 Kw x 6 P
SLOW	SPEED	10.0 M/MIN
	MOTOR	0.2 Kw x 8 P
DUAL	SPEED	20.0 / 10.0 M/MIN
	MOTOR	0.4/0.2 Kw x 4/8 P
POWER SUPPLY	3Ø, 220~575V, 60Hz	
CONTROL VOLTAGE	1Ø, 110~230V, 60Hz	
OPERATING METHOD	1Ø -48V / 110V -60Hz	
LOAD CHAIN SPEC.	PUSH BUTTON TYPE	
WIDTH OF BEAM	Ø7.1 x 21P x 1 FALL	
RADIUS OF BEAM	100 ~ 150 mm	
RATING	MIN. 1500 mm	
NET WEIGHT	30 MIN.	
	APPROX Min.84.4KG~Max.193KG	

DIMENSIONS

구분	양정 (LIFT)		
	3M~16M	16M~30M	30M~50M
기호	C	600	690
		890	



TITLE OF PROJECT
1.25 TON MOTOR TROLLEY TYPE
ELEC. CHAIN HOIST GENERAL ASSEMBLY

NO.	DESCRIPTION	MATL.	SIZE	QTY	REMARKS
DRAWING NO.	CHECKED	SCALE	DATE	DATE	DATE
DESIGNED	APPROVED	DATE	DATE	DATE	DATE
2013.05.10	2013.05.10				

SCT-1250

SCT-1250

REV	DATE	REASON FOR REVISION	CHECKER BY	APPROD BY
Δ				